



ENERG



LIEBHERR

Re 1400_994790251



90 kWh/annum



126 L



ABCD

2019/2016

Product segments

Refrigeration and freezing

Earthmoving

Material handling

Deep foundation

Mining

Concrete technology
Tower cranes
Mobile and crawler cranes
Maritime cranes
Aerospace and transportation systems
Gear technology and automation systems
Components
Hotels
Solutions
Please enter your search text

Search text

Your language
Your country / region
Ireland
English

Change country

Your language
Your country / region
Ireland
English

Change country

Sales partner search
Wish list
The product was added to your wish list.
Comparison list
The product was successfully added to the product comparison.



LIEBHERR

Refrigeration and freezing
Fridges
Freezers
Wine fridges
Professional
Spare parts
Service
Experience Liebherr

[Corporate home](#)
[Careers](#)
[Contact](#)
[Other product segments](#)

[IRELAND \(EN\)](#)

[BACK](#)

[Overview](#)

[Fridges](#)

[BACK](#)

[to overview: Fridges](#)

[Freestanding fridges](#)

[Fully integrated fridges](#)

[Fridge highlights](#)

[BACK](#)

[to overview: Fridge highlights](#)

[A-rated fridge-freezers](#)

[AutoDoor](#)

[New freestanding appliances generation](#)

[New generation of fully integrated appliances](#)

[OpenStage](#)

[SmartDevice](#)

[Award-winning products](#)

[Refrigeration technologies](#)

[Fridge-freezers](#)

[BACK](#)

[to overview: Fridge-freezers](#)

[Freestanding fridge-freezers](#)

[Fully integrated fridge-freezers](#)

[Side-by-Side fridges](#)

[BACK](#)

[to overview: Side-by-Side fridges](#)

[Freestanding Side-by-Side refrigerators](#)

[Monolith | Exclusive fridges](#)

[BACK](#)

[Overview](#)

[Freezer highlights](#)

[BACK](#)

[to overview: Freezer highlights](#)

[BluRoX](#)

[AutoDoor](#)

[SmartDevice](#)

[Energy-efficient freezers](#)

[Freezing technologies](#)

[Freezers](#)

[BACK](#)

[to overview: Freezers](#)

[Freestanding freezers](#)

[Fully integrated freezers](#)

[Chest freezers](#)

[BACK](#)

[Chest freezers](#)

[Monolith | Exclusive freezers](#)

[BACK](#)

[Overview](#)

[Wine fridge highlights](#)

[BACK](#)

[to overview: Wine fridge highlights](#)

[New generation wine storage fridges](#)

[New generation wine storage fridges](#)

[Wine storage fridges](#)

[BACK](#)

[to overview: Wine storage fridges](#)

[Freestanding wine storage fridges](#)

[Fully integrated wine storage fridges](#)

[Wine tempering fridges](#)

[BACK](#)

[to overview: Wine tempering fridges](#)

[Freestanding wine tempering fridges](#)

[Fully integrated wine tempering fridges](#)

[Monolith | Exclusive wine fridges](#)

[BACK](#)

[Overview](#)

[Hotel and catering industry](#)

[BACK](#)

[to overview: Hotel and catering industry](#)

[Commercial fridges](#)

[Commercial freezers](#)

[Commercial wine fridge](#)

[Bakery](#)

[BACK](#)

[to overview: Bakery](#)

[Bakery fridges](#)

[Bakery freezers](#)

[Food retail](#)

[BACK](#)

[to overview: Food retail](#)

[Supermarket chillers and freezers](#)

[Full glass door freezer](#)

[Supermarket freezers Freezer top](#)

[Laboratory and healthcare](#)

[BACK](#)

[to overview: Laboratory and healthcare](#)

[Laboratory fridges](#)

[Laboratory freezers](#)

[Medical fridges](#)

[Ultra-low temperature freezers](#)

[Drinks refrigeration](#)

[BACK](#)

[to overview: Drinks refrigeration](#)

[Upright drinks display fridges](#)

[Frozen food and ice cream industry](#)

[BACK](#)

[to overview: Frozen food and ice cream industry](#)

[Merchandising chest freezers](#)

[Merchandising upright freezers](#)

[BACK](#)

[Find spare parts](#)

[BACK](#)

[Customer service](#)

[BACK](#)

[to overview: Customer service](#)

[Contact us](#)

[Advice](#)

[BACK](#)

[to overview: Advice](#)

[FAQS](#)

[Data protection](#)

[Downloads](#)

[BACK](#)

[Operating instructions](#)

[Energy label & product data sheets](#)

[Brochures](#)

[Register your guarantee](#)

[BACK](#)

[Experience Liebherr](#)

[BACK](#)

[to overview: Experience Liebherr](#)

[Our history](#)

[Our quality promise](#)

[Inside Liebherr's innovations](#)

[Liebherr owners](#)

[Promotions](#)

[BACK](#)

[10 year top energy guarantee](#)

[5 year guarantee](#)

[Sustainability](#)

BACK

to overview: Sustainability

EcoVadis sustainability rating

Energy efficiency private household

Energy efficiency Professional

Cradle to Cradle

Dealer locator

Refrigeration and freezing

Fridges

Fridges

Re 1400 Pure





ENERG



LIEBHERR

Re 1400_994790251



90 kWh/annum



126 L



ABCD

2019/2016















03/09

Re 1400 Pure

Under counter refrigerator

Exterior dimensions: height/width/depth - 85 / 55 / 60.7 cm

Total volume - 125 l

Noise level - 35 dB

Connectivity solution - —

Super Cool

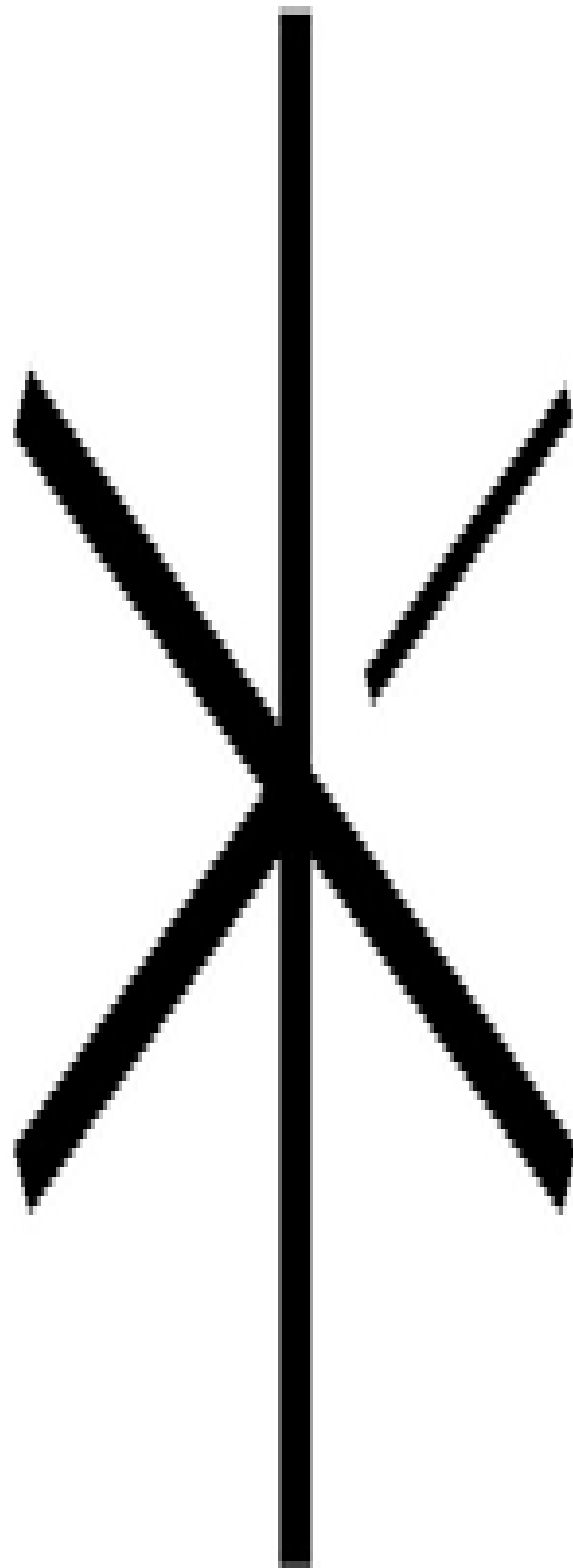

SuperCool

You want your fridge to maintain the optimum temperature, even if you have just put shopping in from the market which has been warmed by the sun? This is a case for SuperCool. Once activated, your Liebherr boosts its performance until the fresh food is as cool as the rest of the contents. SuperCool then switches off automatically.

LED



LED light inside

The LED side lighting illuminates the interior from the side – providing a good overview of your food. Another highlight: the LEDs are positioned in front of the glass shelves so that even a full refrigerator is well lit.

Touch Control



TouchControl

A gentle finger tap and you set your Liebherr to 3, 5, 7 or 9° with TouchControl. So simple – and efficient, as the sleek button is integrated into the interior, creating more space for all your fresh goods.

**Door
Stop**

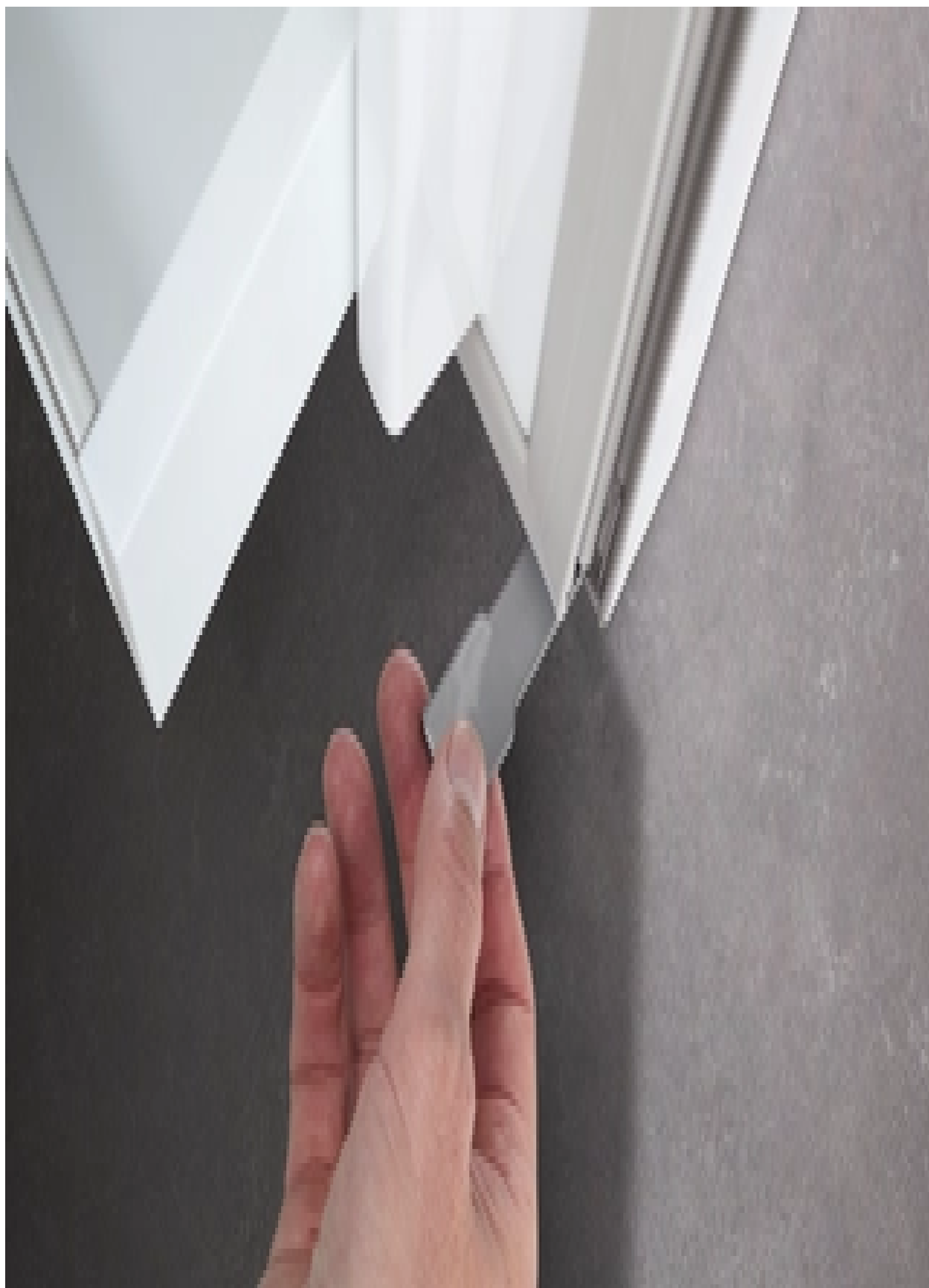

DoorStop

Keep your Liebherr fresh and odour-free with our retractable DoorStop. Prevents odors by keeping the door open when not in use. Save time and energy.

TO ALL HIGHLIGHTS



PRODUCT DATASHEET

VISIT RETAILERS



Compare

Features

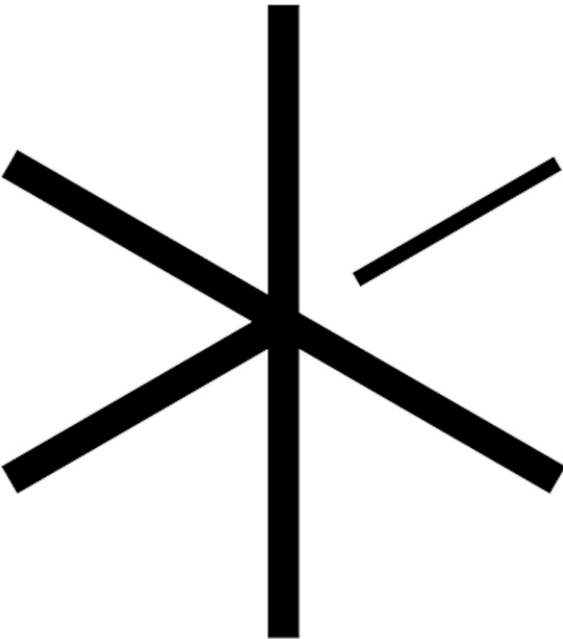

SuperCool

You want your fridge to maintain the optimum temperature, even if you have just put shopping in from the market which has been warmed by the sun? This is a case for SuperCool. Once activated, your Liebherr boosts its performance until the fresh food is as cool as the rest of the contents. SuperCool then switches off automatically.



LED light inside

The LED side lighting illuminates the interior from the side – providing a good overview of your food. Another highlight: the LEDs are positioned in front of the glass shelves so that even a full refrigerator is well lit.



TouchControl

A gentle finger tap and you set your Liebherr to 3, 5, 7 or 9° with TouchControl. So simple – and efficient, as the sleek button is integrated into the interior, creating more space for all your fresh goods.



DoorStop

Keep your Liebherr fresh and odour-free with our retractable DoorStop. Prevents odors by keeping the door open when not in use. Save time and energy.



Slimline handle with integrated opening mechanism

The sturdy, secure handles have an elegant, premium quality appearance and feature an integrated opening mechanism, which allows convenient and effortless door opening.



Durable worktop

You can never have enough worktop space when cooking. That's why our Undercounter appliances come with a sturdy and durable surface that even withstands scratches and thereby serves as an extension of your working top.

Additional features

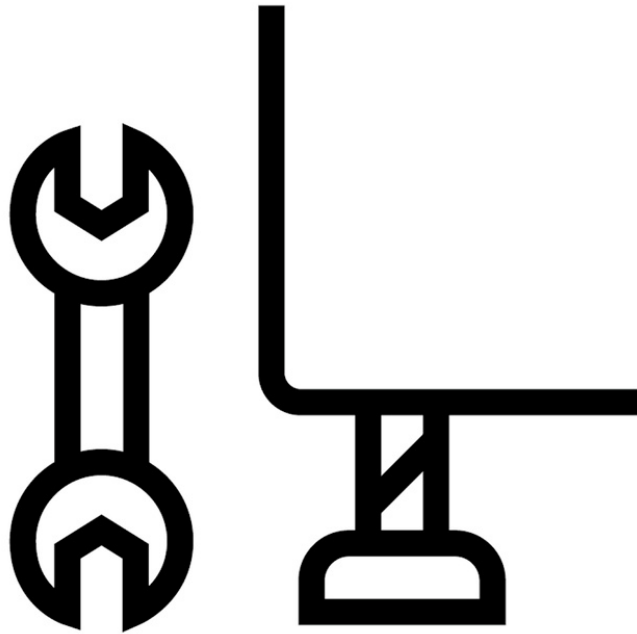

Adjustable feet

Two adjustable feet mean the appliance can be perfectly fitted and adjusted to its surroundings, e.g. on uneven ground. This means you can be sure that the fridge door closes completely, no heat can enter and no condensation can form. That saves both energy and money.

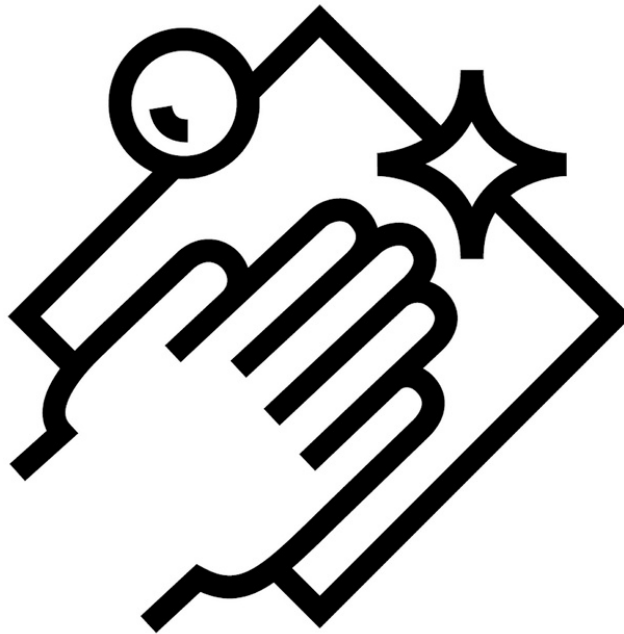

Dishwasher-safe features

The features of your Liebherr are practical in two ways: Not only do they simplify everyday use, they are also very easy to clean. Does the butter dish, FlexSystem or ice cube tray need to be cleaned? Just put them in the dishwasher. Then you'll have more time for other things.

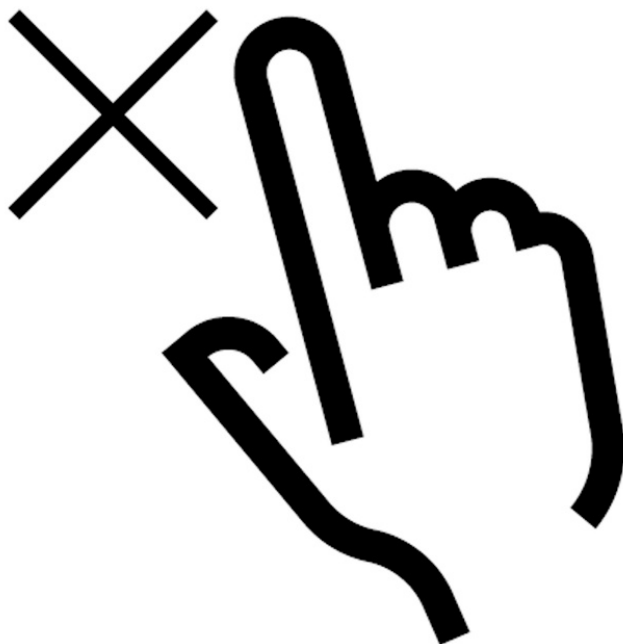

Display lock

An illuminated display is a magnet for children's hands – your Liebherr also knows that. That's why there is the display lock. It ensures the settings on your refrigerator are not changed unintentionally. You can also, of course, simply deactivate the display lock.

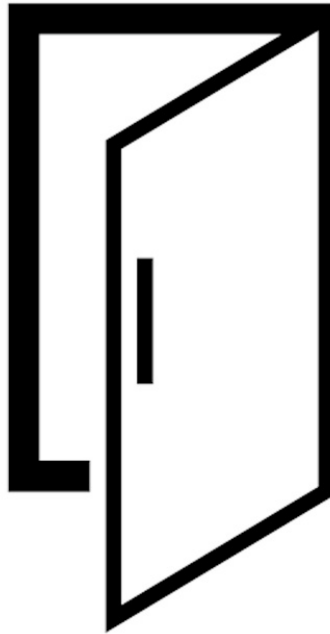

Door alarm

Your Liebherr's door alarm ensures that you don't use up energy unnecessarily and spoil food. The moment the fridge door is left open for too long, it alerts you – with a pulsating light and a warning tone.



Door shelf

Do you want a safe storage area for your drinks or food? And do you still want to reach them easily? Our door shelves offer you both. They are height-adjustable and therefore meet all your requirements. The sliding and removable bottle holder is also convenient. This holds your bottles securely at all times.



Height-adjustable door shelves

Use all of the space in your Liebherr – and entirely to suit your requirements. The height adjustable inner door shelves will help with this: These allow you to change the height at which the shelves are mounted quickly and easily at any time – which means they can be used entirely flexibly and securely for storing a wide range of containers and food.

Additional features

Technical data

General product information

Output and consumption

Control and functions

Refrigerator compartment

Design and materials

Set-up and installation

Specifications

Exterior dimensions: height/width/depth

85 / 55 / 60.7 cm

Exterior dimensions: height/width/depth (with packaging) 911.0 / 567.0 / 711.0 mm

Weight (without packaging)	33.10 kg
----------------------------	----------

Weight (with packaging)	35.60 kg
-------------------------	----------

Total volume **	125 l
-----------------	-------

Volume, refrigerator compartments	126 l
-----------------------------------	-------

*

SmartDevice functionality based on availability

**

In accordance with Regulation EU 2019/2016, we show the total volume as an integer (rounded down) and the volume of the freezer and freshness compartments with one digit after the decimal point. The complete range of efficiency classes can be found on page 9. According to (EU) 2017/1369 6a. The term "volume" refers to the term "total volume" mentioned in the current regulation.

Downloads



Operating instructions
PDF (3.6 MB)

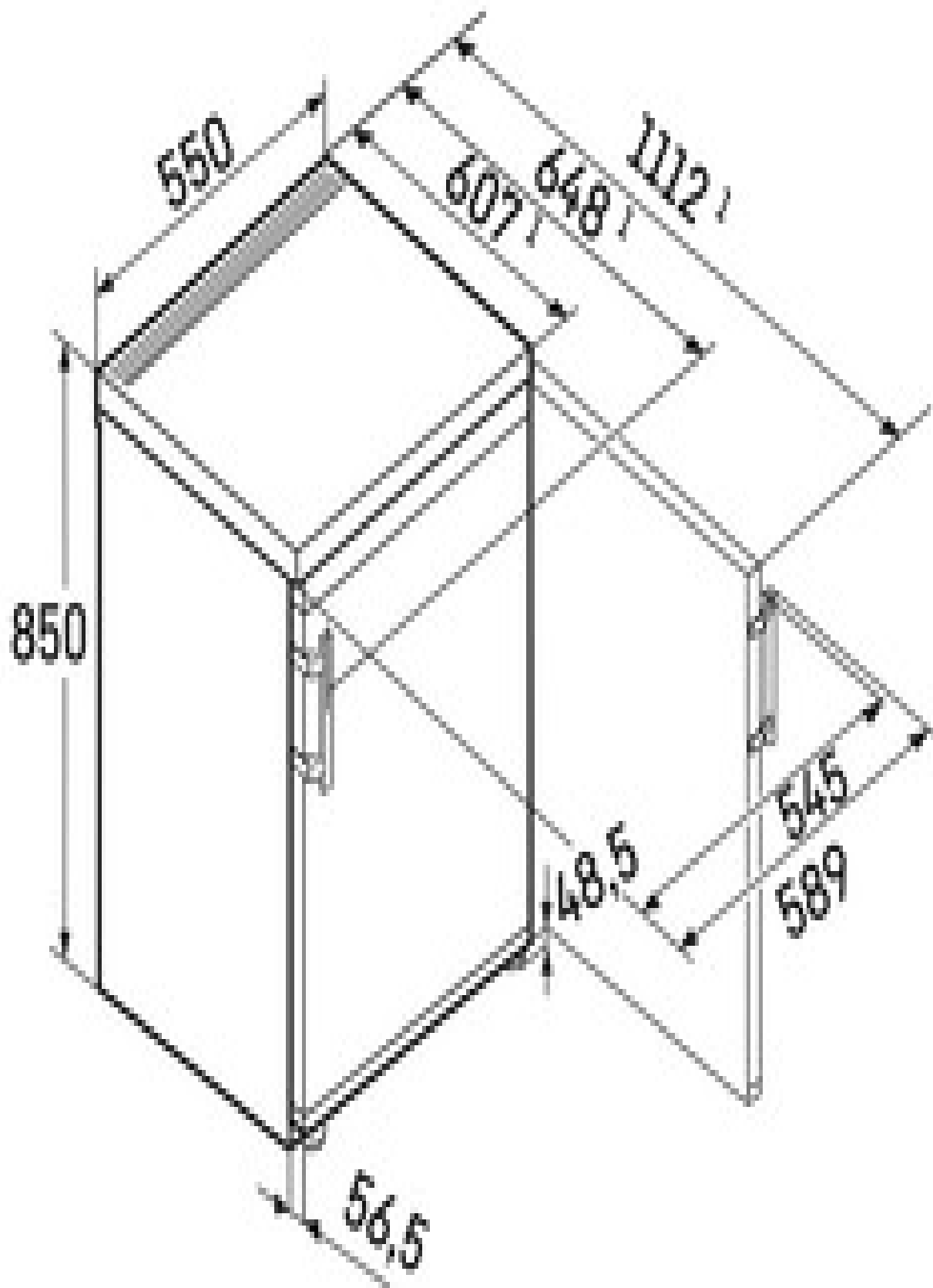

Dimensional drawing
JPG (0.1 MB)

3D

3D data
ZIP (0.3 MB)

CE-Certificate

PDF (0.3 MB)

Please note: Despite careful data maintenance, we reserve the right to make technical changes and there may be errors and deviations in the image and text content compared to the original appliance.

Ireland (EN)

ContactCareersCorporate home

Products

Fridge

Fridge-freezer

Side-by-side fridge

Freezer

Chest freezer

Wine fridge

Commercial refrigerator

Service

Customer service

Sales partner search

Company

About Liebherr

Liebherr worldwide

Careers at Liebherr

Our responsibility

Follow us on Social Media

Functions

ImprintPrivacy Policy Legal informationPrivacy Setting